



**Duckworth & Kent**  
titanium surgical instrument manufacturer

*at the leading edge*

# *Essential* CATARACT SET

The decision to choose our reusable instruments over single-use alternatives is a simple one. Not only are you investing in world-renowned high quality titanium alloy products, but also in instruments that have less impact on the environment and are more cost-beneficial in the long term.

When you invest in a Duckworth & Kent instrument you are purchasing a product that will serve you impeccably for innumerable years and countless procedures.



Cost Effective  
& Eco-Friendly

Find us on



This leaflet comprises three sections:

### A Sub-Tenon's Selection

A recommended set of instruments used for administering local anaesthetic into the sub-Tenon's space prior to surgery.

### B Essential Cataract Set

A series of 5 sub-sections offering a choice of essential instruments required for cataract surgery: **B1**: specula; **B2**: forceps; **B3**: capsulorhexis forceps; **B4**: manipulators; **B5**: irrigation & aspiration.

### C Occasional Range

An extremely useful collection of instruments that may be required on an occasional basis. This encompasses situations such as blepharospasm or small inter-palpebral fissures; suturing wounds; weak zonules or capsule dehiscence; challenging nucleus cracking; explanting IOL implants; iris and IOL implant manipulation.

## Sub-Tenon's Set

A

9-551

Barraquer Adult Speculum

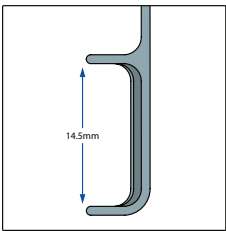

- 14.5mm closed blades
- Angled to rest temporarily
- Single piece construction

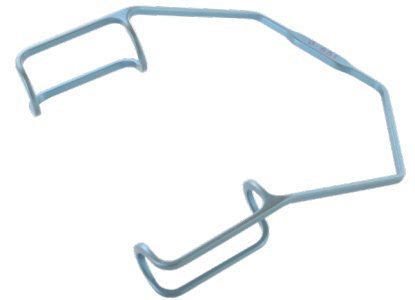

2-510-1E

Moorfields Utility Forceps

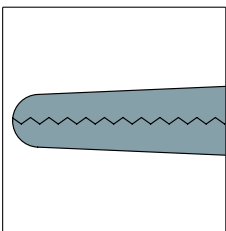

- Delicate serrated tips, 1mm wide
- Straight shafts
- Flat handle, length 115mm



- Design registration number 004383396-0001

1-501B

DK Westcott Style Stitch Scissors (curved)

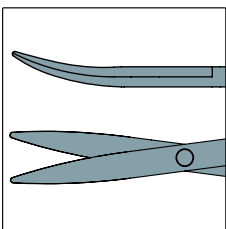

- Blunt tips, curved blades
- Cut length 9mm, tip to pivot length 20mm
- Flat handle, length 115mm



## Essential Cataract Set - Specula

B1

9-551

Barraquer Adult Speculum

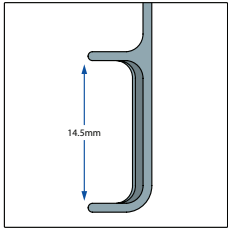

- 14.5mm closed blades
- Angled to rest temporarily
- Single piece construction

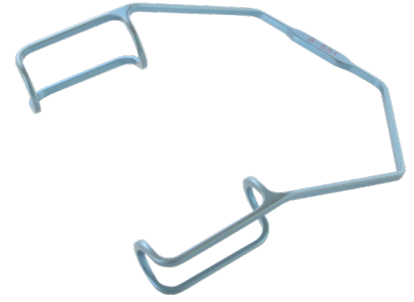

OR

9-556

Kratz Barraquer Speculum

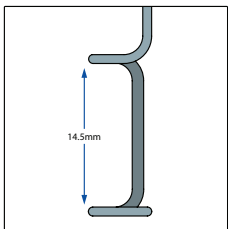

- 14.5mm open blades
- Angled to rest temporarily
- Single piece construction

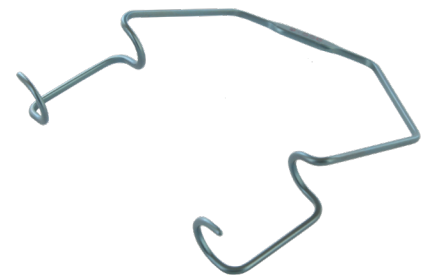

## Essential Cataract Set - Forceps

B2

2-100E

Pierson Notched Forceps

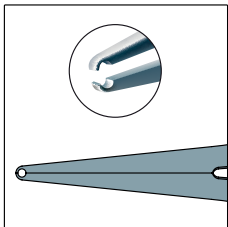

- Pierson 0.25mm notched, 6mm tying platforms
- Straight shafts
- Flat handle, length 90mm



- Design registration number 004383396-0001

OR

2-110E

Bonn Suturing Forceps

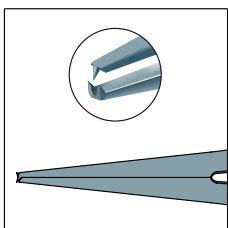

- 0.12mm, 1 x 2 teeth, 6mm tying platforms
- Straight shafts
- Flat handle, length 90mm

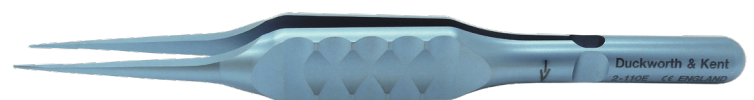

- Design registration number 004383396-0001

## Essential Cataract Set - Capsulorhexis Forceps

B3

2-716GER8-1

Inamura Round Handle Capsulorhexis Forceps

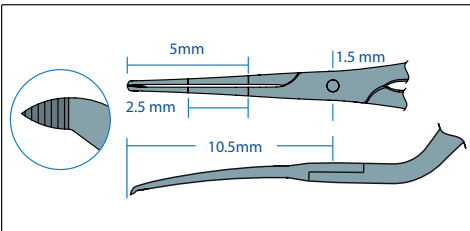

Incisions down to 1.8mm



- Sharp pointed serrated tips
- Cross action tips, 1.5mm width at pivot box
- Curved shaft, tip to pivot point 10.5mm

- Marks on shaft 2.5mm and 5mm denote desired size of capsulorhexis
- Tips angled 45° from shaft
- Round handle, overall length 111mm
- Design registration number 004383396-0001

OR

2-719-3E

Utrata Capsulorhexis Forceps

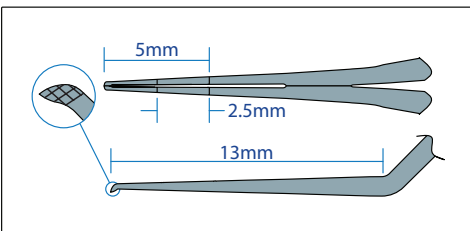

Incisions down to 2.2mm



- Utrata style tips
- Straight shafts, tip to angle length 13mm
- Marks on shaft 2.5mm and 5mm denote desired size of capsulorhexis
- Flat handle, length 86mm
- Design registration number 004383396-0001

## Essential Cataract Set - Manipulators

B4

6-085

Barrett Duo Nucleus Rotator / Manipulator / Splitter

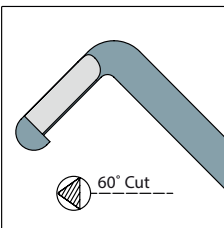

Nucleus Splitter

- Straight, sharp inner/outer sides of tip, length 1.25mm
- Cutting edges 60° to axis
- 45° angled shaft, tip to angle length 14mm



Rotator / Manipulator

- 0.65mm mushroom tip
- 45° angled shaft, tip to angle length 10mm
- Barrett balanced set handle, length 124mm

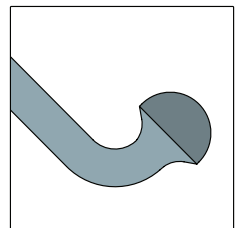

OR

6-496

Drysdale Rotator

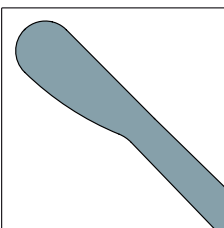

- 0.5mm tip with 1.3mm paddle
- 45° angled shaft, tip to angle length 10mm
- Round handle, length 118mm

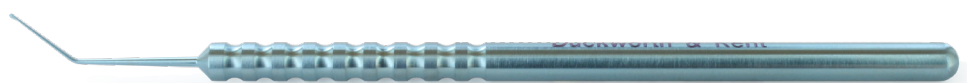

8-652S Short Handle Irrigation Handpiece

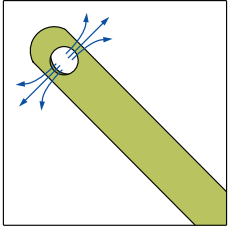

- 23 gauge, 0.65mm tube diameter
- Two 0.4mm side irrigation ports
- Curved shaft, tube length 15mm
- Round handle, length 80mm



8-657S Short Handle Aspiration Handpiece

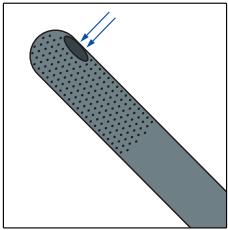

- 23 gauge, 0.65mm tube diameter, textured tip
- 0.3mm aspiration port
- Curved shaft, tube length 11mm
- Round handle, length 77mm



OR

8-711NL I/A Handpiece with Irrigation Luer Lock

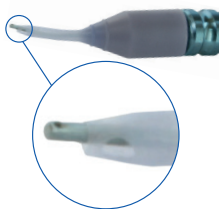
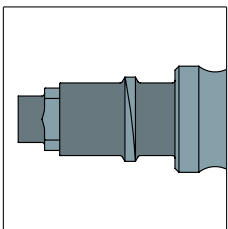

- Round handle, length 115mm
- Luer lock fitting on irrigation port
- Separates for cleaning internal parts
- Single thread at front of handpiece



- Silicone sleeve is pushed onto single thread
- Used with 8-730, 8-731 and 8-732 series DK I/A tips
- I/A tips purchased separately
- Silicone sleeve not included

8-730-1 DK I/A Tip (45° angled tip)

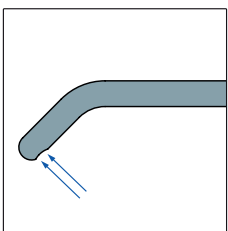

- 22 gauge, 0.7mm tube diameter
- 0.25mm aspiration port
- 45° angled tip



## The Occasional Range

9-588-3

Lieberman Adjustable Speculum

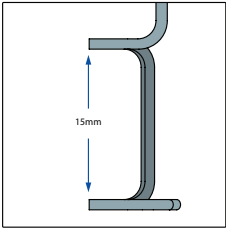

- 15mm open blades
- Angled to rest temporarily
- Adjustable with thumb screw

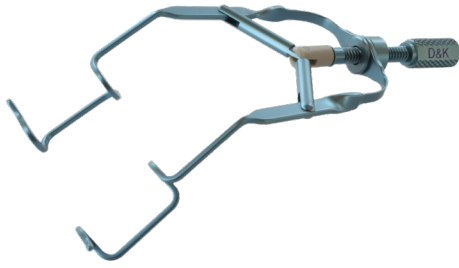

9-590

Barrett Adjustable Speculum

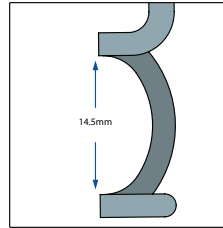

- 14.5mm open blades
- Angled to rest temporarily
- Adjustable with thumb screw

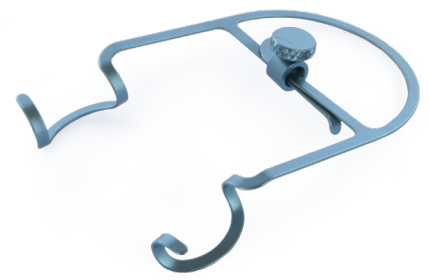

3-205

DK Needle Holder (curved)

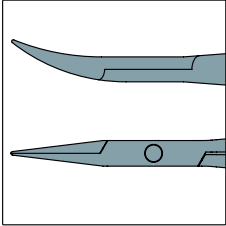

- 7mm delicate curved jaws
- Round handle, tag spring
- Length 108mm



1-110

Vannas Scissors (straight)

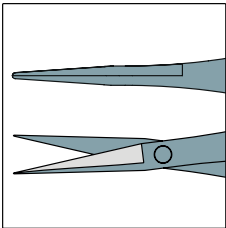

- Sharp tips, straight blades
- Cut length 5mm, tip to pivot length 9mm
- Flat handle, length 97mm



1-705

Osher Angled IOL Cutter

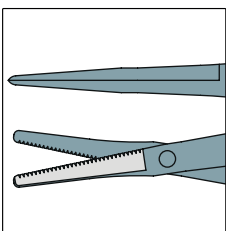

- Blunt tips with micro serrated blades
- Minimum incision size 2.8mm
- Cut length 5mm
- Tip to pivot length 9.5mm
- Flat handle, length 94mm



2-500E

McPherson Tying Forceps

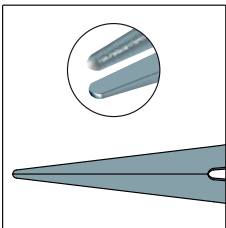

- 6mm tying platforms
- Straight shafts
- Flat handle, length 90mm

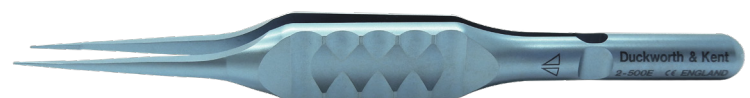

- Design registration number 004383396-0001

Product No.	Product Name	Variation
2-522E	Kelman-McPherson Tying Forceps	Angled tip

6-140

## Mackool Cataract Support System

- (6 to 8 recommended)
- 0.3mm x 2.8mm hook
- Supplied individually

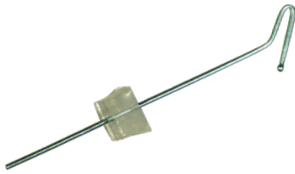

6-135

## Mackool Holder and Sterilising Case

- External dimensions: 19mm diameter, 12mm height
- Internal dimensions: 15mm diameter, 10mm height
- Made from titanium



2-802E

## Brown Nucleus Cracker

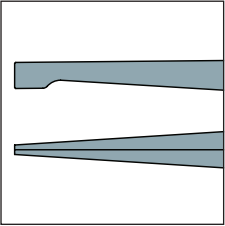

- 1.1mm x 1.2mm paddle style tips
- 30° angled shafts, tip to angle length 14.5mm
- Flat handle, cross action tips length 114mm
- Design registration number 004383396-0001



2-796E

## Nucleus Removal Forceps (serrated tip)

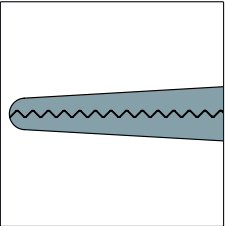

- 4mm serrated tips
- 30° angled shafts, tip to angle length 14mm
- Flat handle, length 88mm
- Design registration number 004383396-0001



6-250

## DK Sinskey Hook

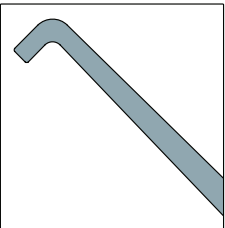

- 0.18mm diameter tip pointing down
- Angled shaft, tip to angle length 10mm
- Round handle, length 119mm



6-400

## Kuglen Iris Hook and IOL Manipulator

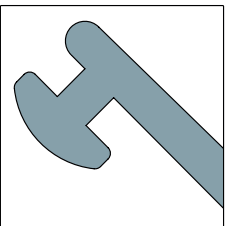

- 0.76mm x 0.75mm x 0.25mm rotator tip
- Push, pull style

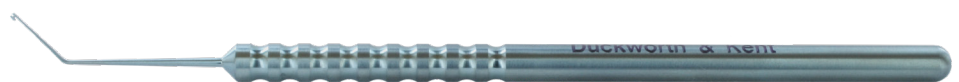

- Angled shaft, tip to angle length 9mm
- Round handle, length 122mm

# Cost Calculator

## for Essential Cataract Set

When compared with single-use alternatives, Duckworth & Kent instruments are not only more cost-beneficial long term, but have a lower impact on the environment.

See how much you can save by investing in our innovative precision engineered reusable titanium product range.



## Cost Effective Precision Engineered Reusable Titanium Instruments



The above chart is an illustration of the costs involved when comparing reusable titanium cataract sets from D&K with a competitor supplying single-use instruments. A cataract set of 6 instruments is comprised of: speculum; toothed forceps; cross-action capsulorhexis forceps, nucleus manipulator / rotator and bimanual irrigation and aspiration handpieces. Illustration based upon an eye unit performing 2000 cataract operations per year with sterilising and cleaning costs of £30 per instrument tray and £20 for the phaco handpiece only. Assumption that a minimum of 28 reusable cataract sets will be required and may incur a reusable repair / replacement rate of 4 instruments per month.

**Maria**  
Customer Service Supervisor



**Kelly**  
Customer Service

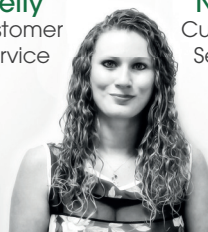

**Nicky**  
Customer Service



If you are interested in our product ranges or have a general enquiry, please contact our dedicated customer service team.

mariagentle@  
kellyobrien@  
nickyguthrie@ } duckworth-and-kent.co.uk

Find us on



© October 2017 Duckworth & Kent  
Revised 30.04.19

Email: [info@duckworth-and-kent.co.uk](mailto:info@duckworth-and-kent.co.uk)

Tel: +44 (0)1462 893254

Fax: +44 (0)1462 896288

[www.duckworth-and-kent.com](http://www.duckworth-and-kent.com)

D&K® is a registered trademark. All other brand names are trademarks or registered trademarks of their respective owners. All schematic line drawings, photographs and copy in this leaflet are fully protected by copyright. No part of this leaflet may be reproduced in any form without prior written permission. We reserve the right to make changes at any time, without notice, in product specifications and availability. Descriptive, typographic, or photographic errors are subject to correction. Name(s) of instruments are often comprised of surgeon's name, combination of surgeons' names or by the category of the instrument.